

SOFITEL

LONDON ST JAMES



A French Welcome

Set in the prestigious St James's area, overlooking Pall Mall and Waterloo Place, the 6-floor Grade II listed building is home to the 5 star hotel Sofitel London St James. The royal address where British heritage meets French hedonism, comprises 183 rooms including 21 suites. Expect the unexpected with the interior design conceived by Pierre Yves Rochon, a legendary figure in the world of luxury hospitality design, as the property fuses contemporary aesthetics with French elegance. From vibrant rooms and Michelin-starred menus to our award-winning spa, quintessential tearoom and glamorous cocktail lounge, we combine French chic and British charm to create an experience that's not just a place to stay, it's somewhere to fall in love with.

At Sofitel London St James the 'Joie de Vivre' or joy of life is embedded in our philosophy through the pursuit of ultimate pleasure. Our hotel outlets boast variety from the Michelin star restaurant Wild Honey St James by acclaimed chef Antony Demetre. Indulge in our one of a kind afternoon tea at the Rose Lounge. Or opt for the intimate ambiance of the St James Bar, our iconic cocktail destination. Our guests can also take advantage of the Sofitel Spa to relax & rejuvenate with one of many sophisticated treatments that offer a transformative experience of the highest quality.

Much more than function rooms, our collection of 12 versatile spaces can be configured to suit a variety of corporate events. A dedicated event team take care of every detail from audio visual equipment to elegant stationary. While Executive Chef Martin Horsley creates delicious menus for business lunches though to cocktail receptions.



ACCOMMODATION

- 183 ROOMS IN TOTAL
- 8 JUNIOR SUITES
- 4 STUDIO SUITES
- 2 DELUXE SUITES
- 4 PRESTIGE SUITES
- 1 ST JAMES SUITE
- 1 OPERA SUITE

RESTAURANTS & BARS

- WILD HONEY ST JAMES (MICHELIN STAR)
- BISTROT AT WILD HONEY
- ST JAMES BAR
- THE ROSE LOUNGE
- 2 PRIVATE DINING ROOMS

FACILITIES

- SOFITEL SPA
- 24-HOUR SOFITEL FITNESS SUITE
- 24-HOUR IN-ROOM DINING
- BUSINESS SUITE
- CONCIERGE
- VALET PARKING
- LAUNDRY SERVICE
- NEWSPAPER DELIVERY
- COMPLIMENTARY WI-FI

MEETINGS & EVENTS

- 12 MEETING SPACES IN TOTAL
- 3 BOARDROOMS
- CAPACITY FOR UP TO 200 GUESTS
- FLEXIBILITY TO ACCOMMODATE LARGE SCALE EVENTS
- DEDICATED EVENT SPECIALISTS
- SEPARATE M&E ENTRANCE
- FULL SERVICE A/V

STAY CONNECTED

 @SofitelLondon

 @SofitelLondonStJames

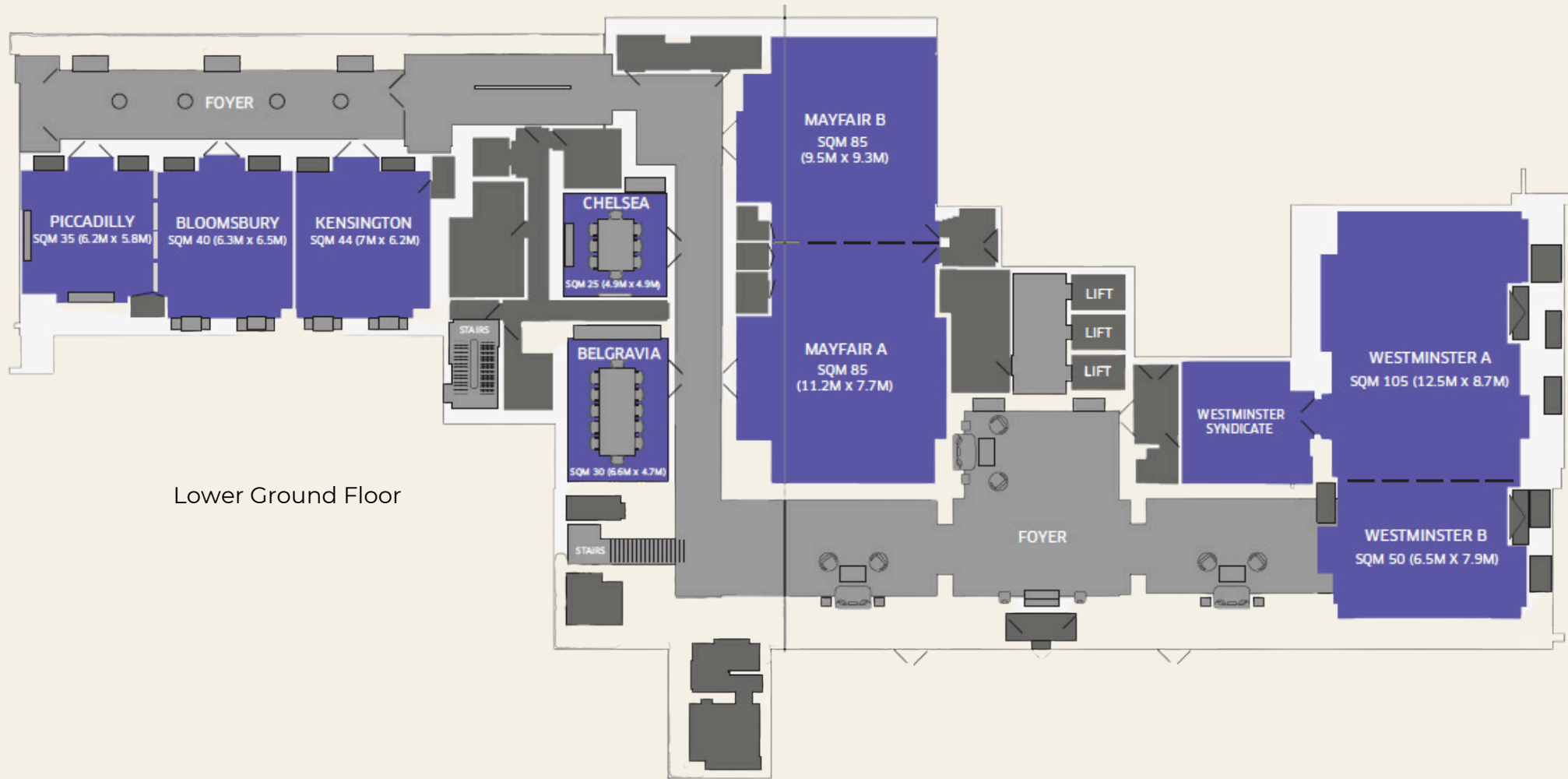

 @SofitelLondonStJames

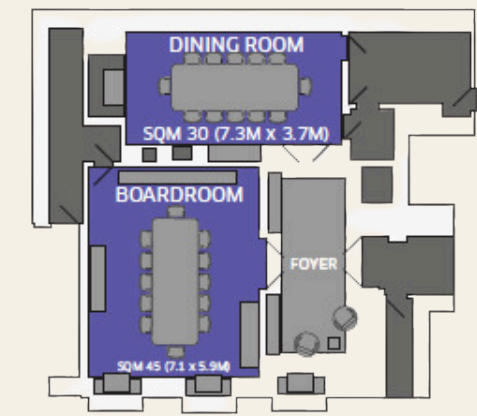

Lower Ground Floor

Ground Floor

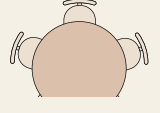
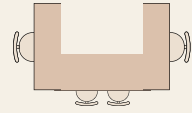
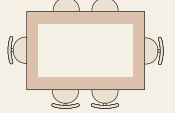
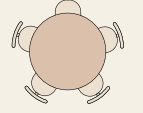
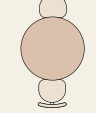

Room Name	Area in Square Metres	Area in Square Feet							
Westminster	155	1750	200	90	120	50	54	150	180
Westminster A	105	1200	130	60	64	30	30	100	120
Westminster B	50	540	40	20	32	20	20	40	40
Mayfair	195	2100	170	80	96	50	54	130	180
Mayfair A	85	950	80	40	48	21	24	70	-
Mayfair B	85	950	80	40	40	21	24	50	-
Piccadilly & Bloomsbury	80	860	70	50	40	25	30	50	60
Piccadilly	35	380	30	24	16	18	12	20	30
Bloomsbury	40	480	35	24	16	18	18	20	30
Kensington	44	460	30	20	-	-	15	-	20
Belgravia	30	330	-	-	-	-	12	-	-
Chelsea	25	260	-	-	-	-	8	-	-
Boardroom	45	440	-	-	-	-	12	-	-
Private Dining Room	30	290	-	-	-	-	12	-	-

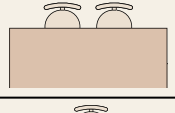
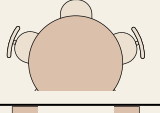
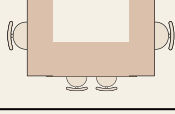
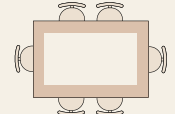
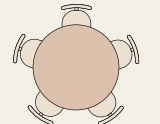
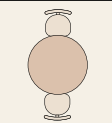
YOUR EVENT SET-UP	
	Theatre
	Classroom
	Cabaret
	U-Shape
	Boardroom
	Banquet
	Standing Reception





Initiatives

Energy Efficiency Management

Envelope Improvement, LED lighting upgrades, and reporting on energy consumption and CO2 emissions.

Local and Organic Suppliers

We're dedicated to partnering with and supporting local and organic suppliers, empowering them whenever possible.

Sustainable Waste Handling

We segregate our waste whenever feasible and have introduced an **ORCA machine** to process our food waste sustainably onsite. We've processed **51.5 tonnes of waste in a sustainable manner.**

Water

We're actively reducing our reliance on bottled water by implementing refillable water bottles and Brita water filter machines across all food and beverage outlets.

Our Actions

Food and Beverages

- We are measuring our food wastage and processing it in a sustainable manner by using our ORCA machine.
- We are using the food waste data, to reduce the amount of food waste we create.
- We prioritize local and sustainable suppliers and centralise our purchases.

Technical

- Energy saving LED lights are used throughout the building.
- We strive to reduce our water usage wherever possible
- Smart sensors for windows in rooms are connected to AC to switch off.

Spa

- Water decanters are placed around the spa to eliminate any use of plastic bottles along with a water filter tap
- The hotel's main spa brand, SOTHYS, is sustainable with active ingredients sourced responsibly with shorter supply chains to reduce carbon emissions

Social

- We strive on being diverse and offering equal opportunities with 47% of our employees identifying as women and celebrating over 43 nationalities in the hotel.
- We have also created and are executing a diversity and inclusion calendar
- We encourage volunteering and continuously work on improving our efforts

In-House

- Paper, glass, and metal liner are recycled, and where possible recycled by our waste company.
- We are single use plastic free in the front of house and working on bringing this to the back of house as well.
- All our staff members are using reusable water bottle.

Achievements

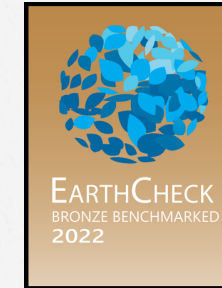

Earth Check

We earned Earth Check Bronze benchmark status in 2023 and are now striving for Earth Check Silver certification by 2024.



Green Key

We were awarded the Green Key certificate in 2023.



HSMAI Europe Awards

Sofitel London St James was a finalist for the Sustainability Award at the HSMAI Europe Awards.

Click [here](#) find out more about our CSR and Social Responsibility Commitment.